

# MANUAL

This is a precision instruction, please make sure you read this carefully before you try your first ride. If you doubt about any information inside this instruction, please contact us or your local distributor .

## Meet your Ebike

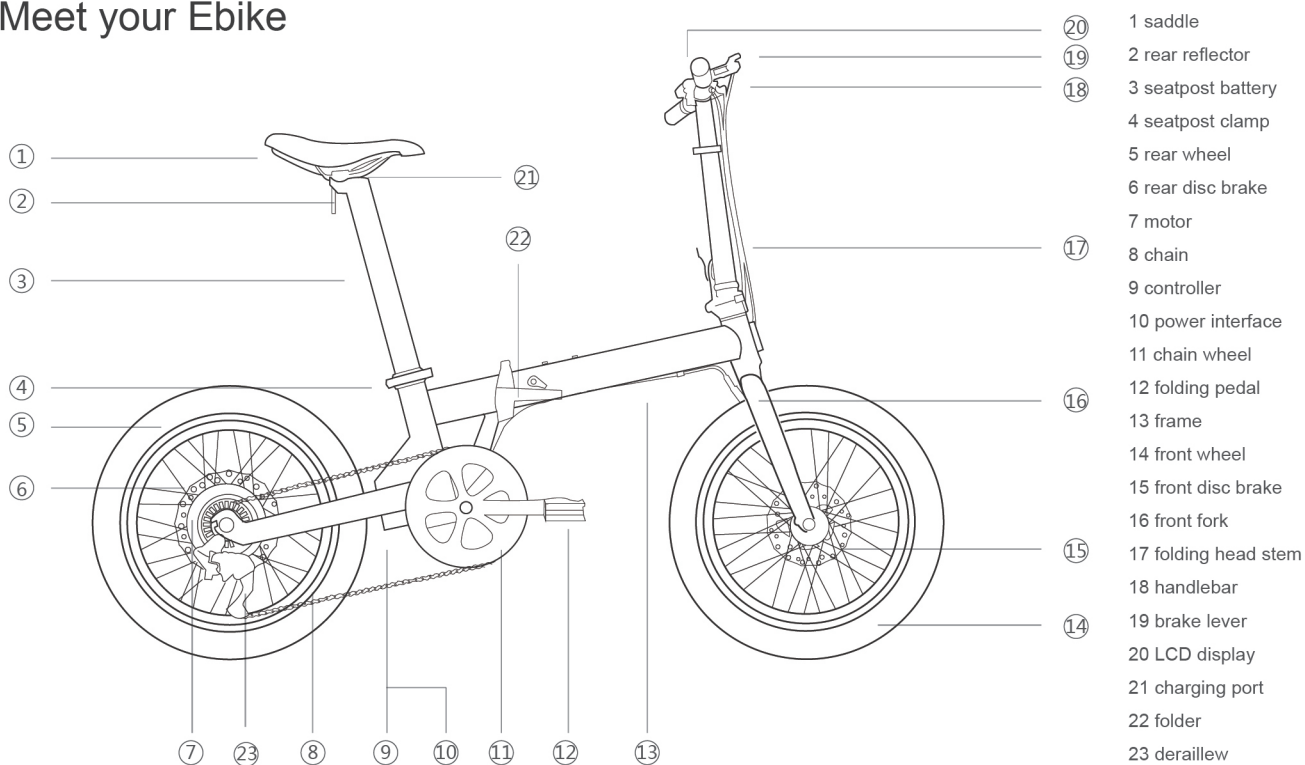

## Paremeter

Product name: Volador

Model name: QSEB02

Size: 1470\*580\*1120mm

Folded size: 820\*370\*680mm

Wheel base: 1007mm

Net weight: 36lbs

Range: 31miles (PAS )

Max. load: 220lbs

Max. speed: 20MPH

Charging time: 3 Hrs

Battery type: Samsung Lithium-ion

Battery capacity: 36V 7.0Ah

Noise : ≤ 62 dB(A)

Motor : MXUS 350W brushless geared DC motor

Rated output power: 350W

Motor efficiency: ≥80%

Rated RPM: 265±10r/min

Rated voltage: 36V

Max torque: 40N.m

Overcurrent protection: 12±1A

Low-voltage protection: 30±1V

Kwh: ≤1.2Kw.h

Modes: 5 levels + throttle + walk assist

Tire diameter: 20 inch

Frame: 20 inch 6061 Al-Alloy foldable

Front fork: 20 inch 6061 Al-Alloy

Brakes: 160mm disc brakes

Rim: 20 inch Al-Alloy 13G36H

Tire: Kenda 20\*1.95

Chain wheel: Prowheel 52T

Free wheel: Shimano 7 speed

Front hub: Sigma Al-Alloy

Chain: KMC

Handle bar: Promax

Display: Kunteng LCD

Controller: Kunteng sine wave FOC

Brake levers: Al-Alloy e-bike lever

Saddle: KNUS

Pedal: foldable pedals

## Fold your Ebike

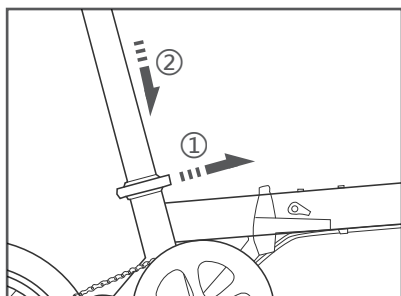

1. Hold firmly the seat post (important), loosen the clamp.
2. Push the seat post slowly towards the ground, tighten the seat post clamp.

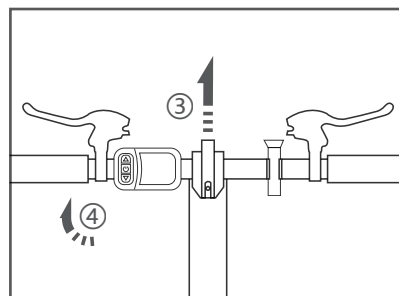

3. Loosen the handle bar clamp.
4. Turn the handlebar clockwise until vertical, and then tighten the clamp.

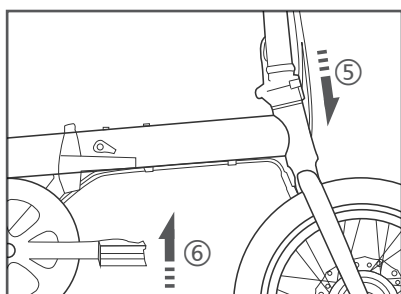

5. Release the lock clamp downwards, then fold the head tube downwards.
6. Fold the pedal by pushing it up.

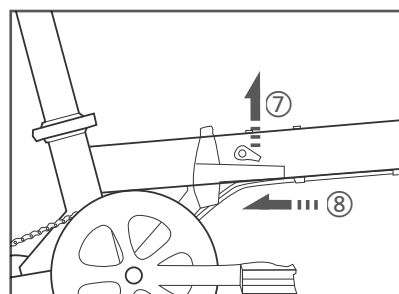

7. Release the safety cap upwards.
8. Pull the lock bar, fold the main tube backwards.

## Operate your Ebike

A.Press & hold power button for 3 sec, LCD shows screen A, data displays single riding time - PAS class-speed-single range;

B.Press power button, LCD shows screen B, data displays total riding time -PAS class – average speed-total range;

C.Press power button twice, LCD shows screen C, LCD shows screen C, data displays total riding time - max speed-voltage.

Press & hold power button to turn off

▲ Up      ⏻ Power      ▼ Down      ☰ LCD backlight      🚶 Slide mode

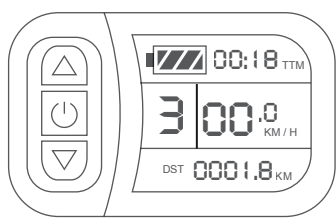

I

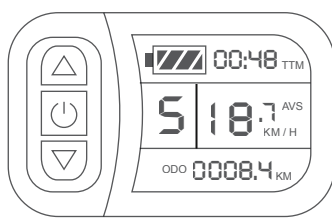

II

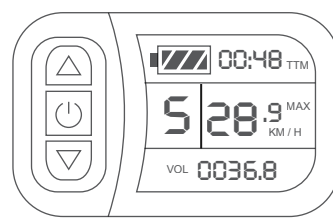

III

1. Slide mode: press & hold DOWN button until 🚶 flicker, your E-bike will move at a fixed speed of 6KM/H, then release to quit.
2. Cruise mode: keep your E-bike riding to your required speed (must be over 7KM/H). Press & hold DOWN button for 3 sec to enter cruise mode, use brake or press any button to quit.
3. LCD backlight: press & hold UP button to turn on backlight, press & hold UP button again to turn off.
4. PAS mode: press UP or DOWN button to choose PAS classes from 0~5.

## Charge your Ebike

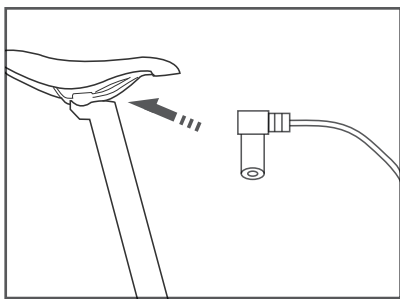

Charging port is right beneath the saddle, covered by a rubber dust-free cover. Uncover it, plug the charger into the port; and then cover the port again when charged.

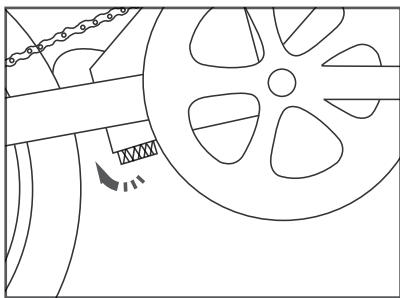

If you want to charge your battery separately, roll out the power port, release the seat post clamp, pull out the seat post battery, then repeat the steps above.

## Accessory list

- 1 front mud fender
  - 2 rear mud fender
  - 3 reflectors
  - 4 ring
  - 5 lamp
- Please mount accessories according to your needs.

## Attention

### Battery & Charge

1. Red indicator on the charger means charging, when it turns green, please stop charging your battery;
2. Do not expose to temperature  $-20^{\circ}\text{C}$  or  $> 35^{\circ}\text{C}$ , Fully charge the battery and store separately. Charge the battery regularly, do not leave it uncharged for a long time, or the battery may self-discharge and be damaged. This damage is not covered under the Limited Warranty;
3. Never expose your battery to damp environment or soak into water, never short circuit the battery terminals, this damage is not covered under the Limited Warranty;
4. Charge with the original charger only;
5. Do not disassemble/punch battery pack. Do not place it in fire or drop from any height. Avoid contacting with other contacts;
6. Turn off E bike's power before charging. Plug into the charge port first then the AC plug;
7. Do not cover any items on the charger during charging;
8. Pull out charge port before the AC plug;
9. Please keep battery out of reach from children;
10. The capacity of Li-battery will decrease when  $-10^{\circ}\text{C}$ ;
11. Recycle or dispose of in accordance with local regulations.

### Ride & Maintenance

1. You must ride with your helmet and follow the local laws and regulations;
2. Read this instruction carefully before riding your E bike;
3. Start your ride with the 3rd PAS class;
4. Keep head tail lamps on at night;
5. Fully check break system, tire pressure and battery life before riding;
6. PLEASE use front break FIRST when braking;
7. Do not ride fast;
8. Do not ride through water over 15cm;
9. Replace the quick wearing parts (e.g., brake pad) when due;
10. It is not recommended for Juveniles, Pregnant women and persons that are Intoxicated/illegal drugs affected to operate your E-bike;
11. Keep your E-bike away from damp, high temperature or corrosive environment;
12. Keep your E bike away from sun-scorched and raindrenched areas;
13. Check screws, chain and other parts regularly.